

Existing Site Section D-D

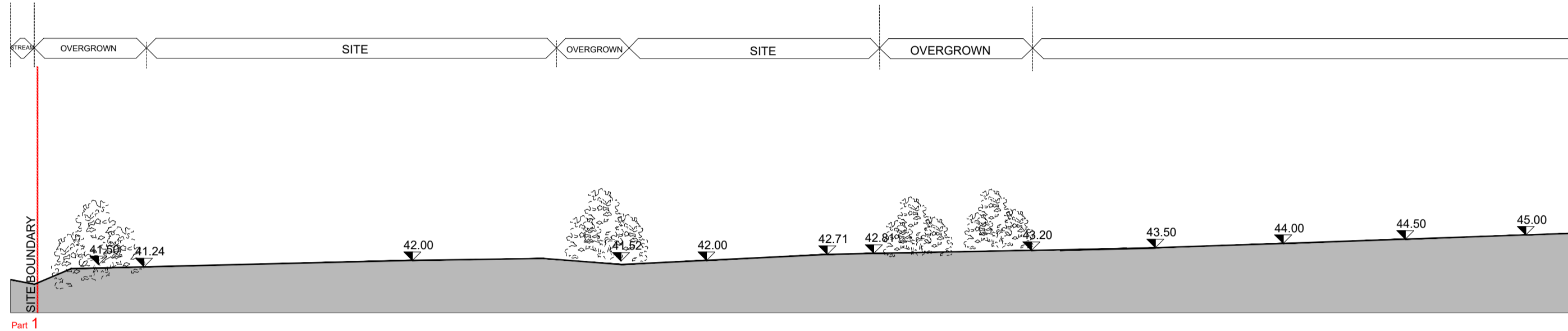

Existing Site Section D-D

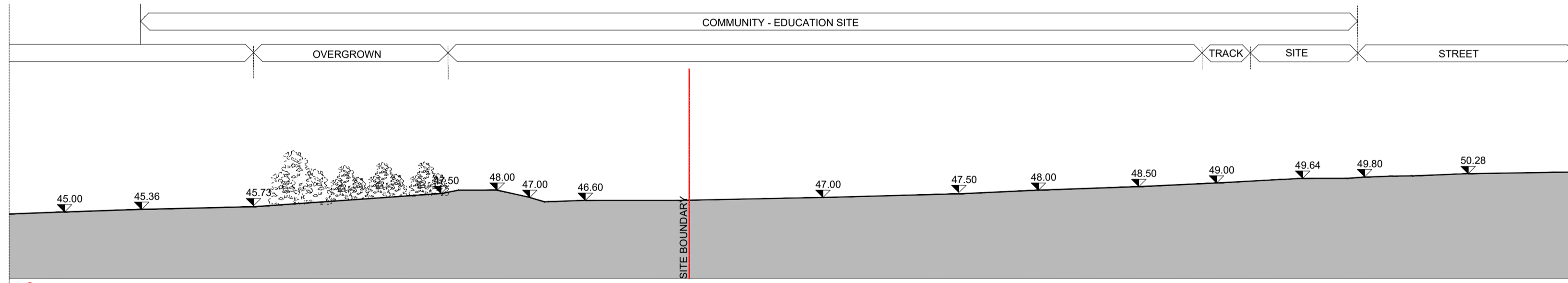

Key Plan

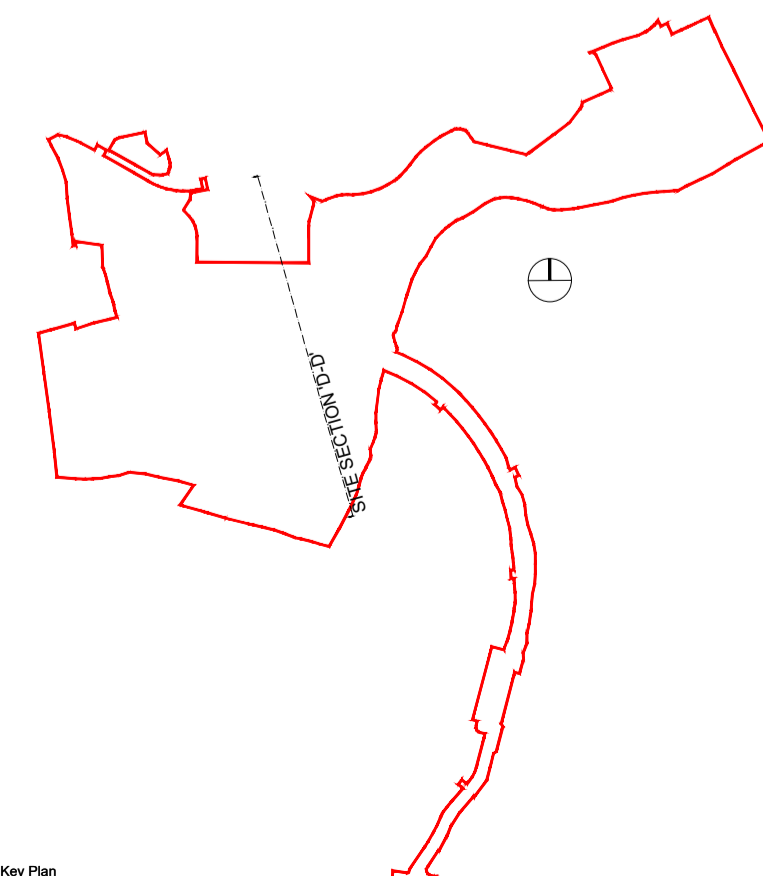

Notes:
 Do not scale from this drawing. Use figured dimensions in all cases. Verify dimensions on site and report any discrepancies to the architect immediately. This drawing is the result of consultation with the architect's specification, Fire Certificate, LDC, other controls issued drawings and reports. Contractor is responsible for:
 1. All dimensions, quantities and performance requirements to be confirmed on site.
 2. All information that pertains solely to the fabrication processes or to the techniques of construction.
 3. All coordination of the work of all trades.
 4. Assuming consistency with the contract documents.
 © This drawing is copyright and may only be reproduced with the architect's permission.

Drawing Notes:

 Buildings to be Demolished
 Total Area 334.27 m²

REV	DATE	BY	DESCRIPTION
P04	27/01/21	LB	Issued for Planning
P03	26/11/2020	LB	Issued for Information
P02	31/01/20	LB	Issued for Information
P01	19/12/18	LB	Issued for Information

reddy architecture + urbanism

Reddy Architecture + Urbanism
 41 Dean Street,
 Kildenny,
 R55 P291

T: +353 (0)56 7762697
 W: www.reddyarchitecture.com
 E: info@reddyarchitecture.com

Client Details:
 AXIS Construction

Project Details:
 Proposed Residential Development
 at Cionatín, Gorey

Drawing Title:
 Existing Site Section D-D

Job No: P19-147K	Date: 05/12/2019	Scale@A1: 1:2000 - 1:500
Status: 03 Design Development	Drawn By: LB	Checked By: MK
Purpose: Planning	Revision	
Drawing Number P19-147K-RAU-XXX-XXDR-A-33004		Revision P04